

SLIMLINE TRACKER

Simplicity began building the Slimline Tracker over 25 years ago, initially for the cotton industry to assist with planting and inter-row cultivation operations in raised bed farming. The original units had a chain/ball guidance system that dragged in the furrow to activate a proportional hydraulic control valve, which moves the complete linkage unit into position.

Today, this process is completed using a secondary GPS receiver fitted onto your tool bar which controls and activates the tractor hydraulic system to move the implement left or right. The result is the ability to bed form and plant in near perfect rows, and from that the ability to accurately inter-row cultivate. Depending on the GPS/Steering system used, you have the option to order the Tracker with a complete Proportional PWM control valve OR your control system may utilise/control the tractor hydraulic bank to directly control the Tracker.

STANDARD FEATURES:

- **Robust Design** - the unit strength is based on using a dual 3" chrome shaft and bushed guide system to cater for low, medium and heavy operations (up to 12m) and wider for low load operations
- **Side Travel** - the linkage slide system is moved by a 3" x 18" stroke cylinder, covering 450mm of travel
- **3PL Connection Layout** - mounting system caters for Cat 2, Cat 3 and Cat 3N. A Cat 4 Tracker can be provided as a specific model
- **Hydraulic Components** - standard with two hydraulic lines to direct to tractor. *Optional with pressure compensated proportional (PWM) control valve*

Simplicity
AUSTRALIA

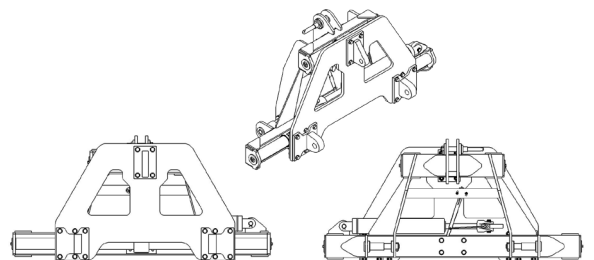

www.simplicityaus.com.au

 FIND US ON FACEBOOK